



**RDL**<sup>®</sup>  
Radio Design Labs

SPECIALISTS IN PRACTICAL PRECISION ENGINEERING™

## HALF-RACK ACCESSORIES

Models HR-RA2

HR-FP1

AMS-HR6

Rack Adapter

Filler Panel

AMS Mounting Panel



HR-RA2 Rack Adapter



HR-FP1 Filler Panel

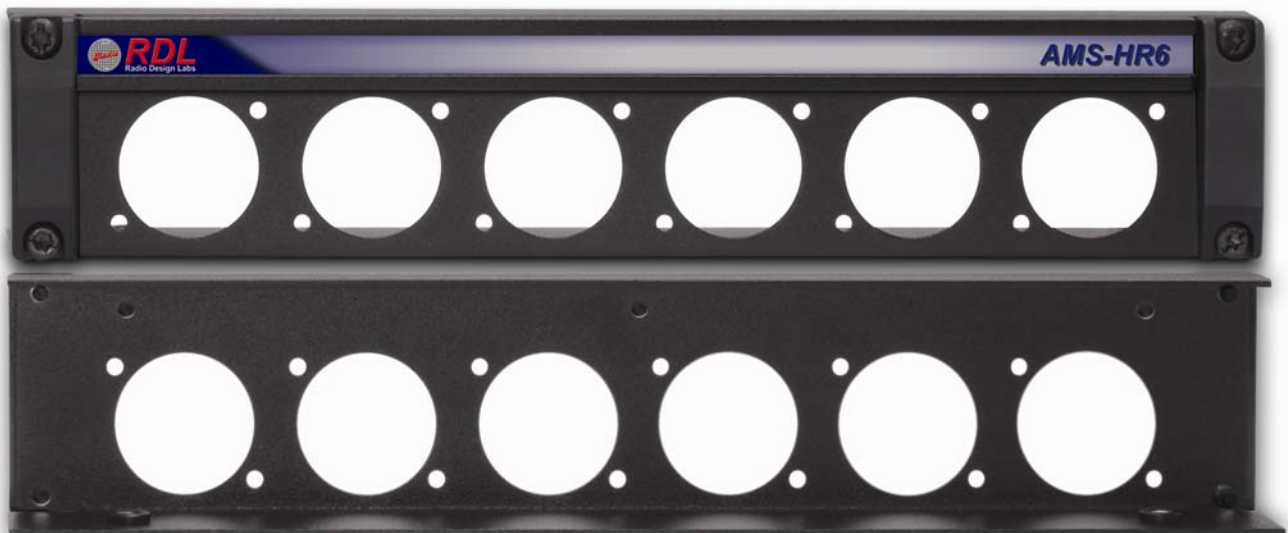

AMS-HR6 AMS Mounting Panel

# HALF-RACK ACCESSORIES

Models HR-RA2 HR-FP1

AMS-HR6

AMS Mounting Panel

Rack Adapter

Filler Panel

AMS Mounting Panel

## Installation/Operation



EN55103-1 E1-E5; EN55103-2 E1-E4  
Typical Performance reflects product at publication time exclusive of EMC data, if any, supplied with product.

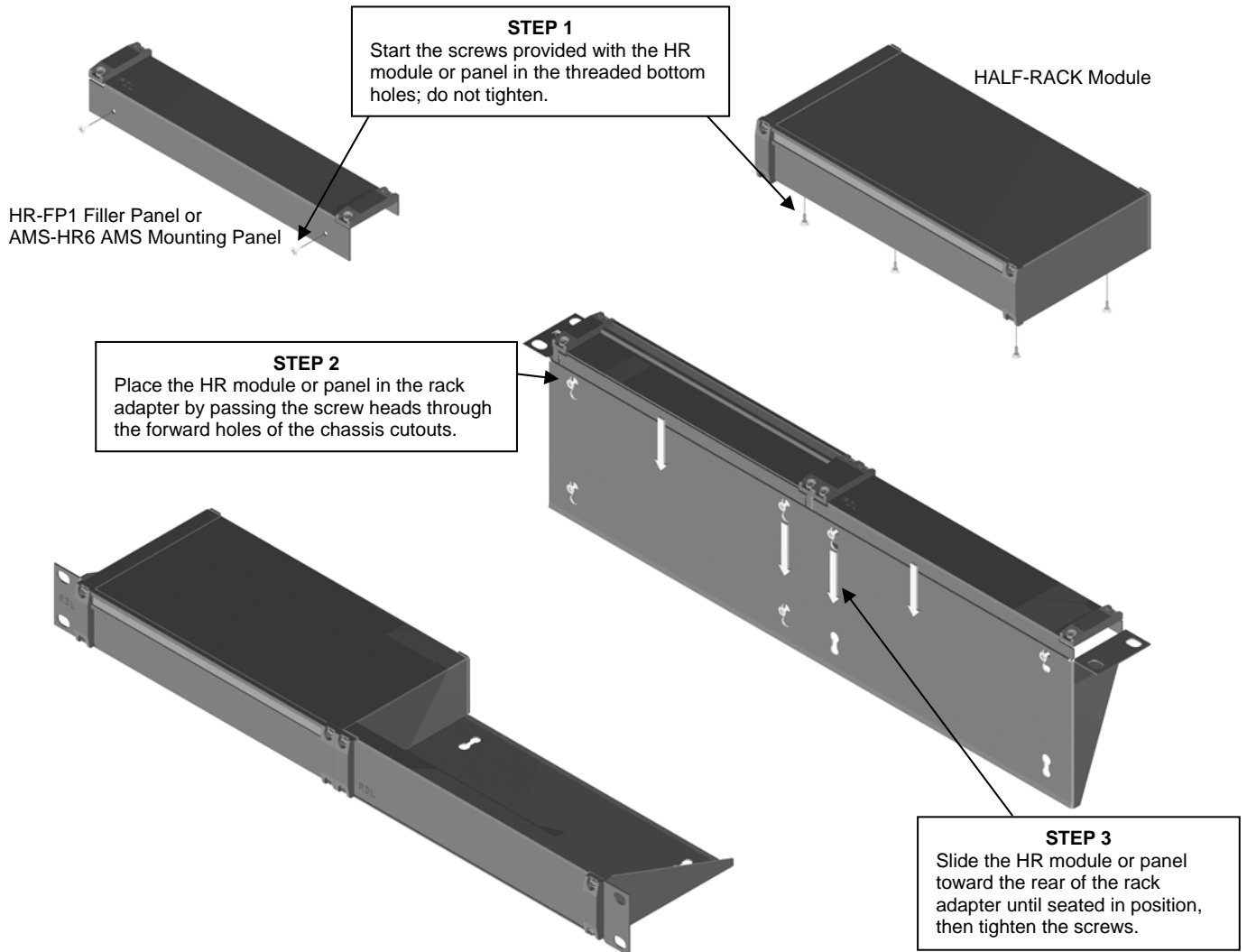

### TYPICAL PERFORMANCE

Construction:	Steel	
Finish:	RDL Black texture	
HR-RA2 Dimensions:	1RU 19" Rack mount	
	Height:	1.75 in      4.45 cm
	Length:	19 in        48.2 cm
	Depth:	4.3 in        10.92 cm
HR-FP1 and AMS-HR6 Dimensions:	Height:	1.7 in        4.3 cm
	Length:	8.6 in        20.6 cm
	Depth:	1.16 in       2.95 cm

Radio Design Labs Technical Support Centers

U.S.A. (800) 933-1780, (928) 778-3554; Fax: (928) 778-3506

Europe [NH Amsterdam] (+31) 20-6238 983; Fax: (+31) 20-6225-287